

# Virage Cranked Espagnolette Handle



- Push button to open
- Handle latches automatically when closed
- Cylinder can be deadlocked with the key
- Locking and Non-locking versions
- Concealed fixing screws
- Right and left handed

The cranked design enhances the ergonomics of the Securistyle Virage handle allowing increased knuckle clearance. The cranked feature means that the handles are left and right handed which needs to be specified on order.

The handle is approved by Secured by Design offering additional security to the window. Non-locking versions are available for use with emergency escape as well as a green button for use with egress windows

**Technical Information:**

- Spindle: 7mm square
- Spindle Length: 9mm, 12mm, 15mm, 20mm, 25mm, 30mm and 40mm
- Fixing centres: 43mm
- Fixing lugs: 10mm
- Sash clearance: 51mm

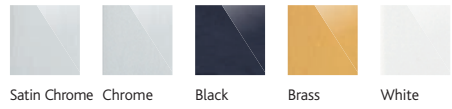
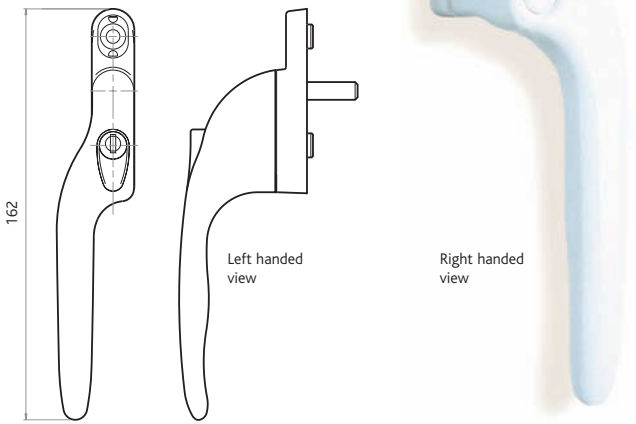

Colour	Button Colour	9mm	12mm	15mm	20mm	25mm	30mm	40mm
<b>Virage Cranked Locking Handle</b>								
White	White	EBC09WH*	EBC12WH*	EBC15WH*	EBC20WH*	EBC25WH*	EBC30WH*	EBC40WH*
Black	Black	EBC09BK*	EBC12BK*	EBC15BK*	EBC20BK*	EBC25BK*	EBC30BK*	EBC40BK*
Chrome	Black	EBC09CH*	EBC12CH*	EBC15CH*	EBC20CH*	EBC25CH*	EBC30CH*	EBC40CH*
Satin Chrome	Black	EBC09SC*	EBC12SC*	EBC15SC*	EBC20SC*	EBC25SC*	EBC30SC*	EBC40SC*
Brass	Black	EBC09BS*	EBC12BS*	EBC15BS*	EBC20BS*	EBC25BS*	EBC30BS*	EBC40BS*
<b>Virage Cranked Non Locking Handle</b>								
White	White	EC09WH*	EC12WH*	EC15WH*	EC20WH*	EC25WH*	EC30WH*	EC40WH*
White	Green	EEC09WH*	EEC12WH*	EEC15WH*	EEC20WH*	EEC25WH*	EEC30WH*	EEC40WH*
Black	Black	EC09BK*	EC12BK*	EC15BK*	EC20BK*	EC25BK*	EC30BK*	EC40BK*
Chrome	Black	EC09CH*	EC12CH*	EC15CH*	EC20CH*	EC25CH*	EC30CH*	EC40CH*
Satin Chrome	Black	EC09SC*	EC12SC*	EC15SC*	EC20SC*	EC25SC*	EC30SC*	EC40SC*
Brass	Black	EC09BS*	EC12BS*	EC15BS*	EC20BS*	EC25BS*	EC30BS*	EC40BS*

\* Insert R for Right Hand, L for Left Hand. Certain spindle sizes available to Order only. Please contact our Sales Office.