

Tokyo

Door Handles

SURFACE
GUARANTEE
10
YEARS

MECHANICAL
GUARANTEE
10
YEARS



- Supplied as Monobloc or Quick Fit
- Standard and long backplates
- 92mm and 62/92mm PZ centres
- Supplied with spindle and screws finished to match backplate
- Reversible handing
- French door options available (page 107)
- Cast aluminium levers and backplate

Colours:

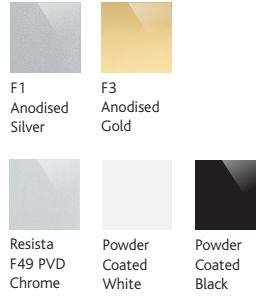

The lever/lever handle set is for use with lift lever operated multipoint locking mechanisms with a 92mm PZ centre with a choice of a standard or long backplate.

The lever/moving pad handle set is for use with 'split spindle' multipoint locking mechanisms, such as the FUHR 859 series. The lever/moving pad handles are available to suit 92mm PZ centres with standard or long backplates, and an offset variant for 62/92mm PZ centre locks (special spindle sets supplied by the lock manufacturer are required for lever/moving pad handles).

92mm PZ std backplate

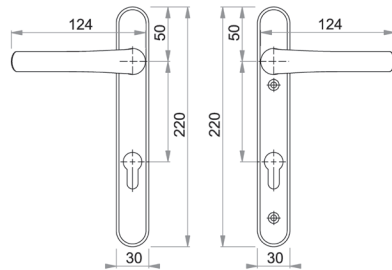

62/92mm PZ long backplate

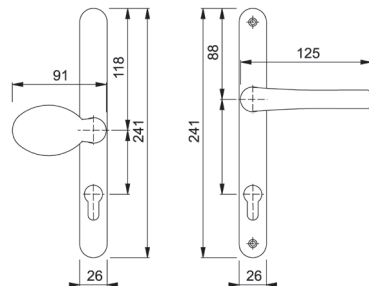

Colour Standard Backplate
92mm PZ

Tokyo Lever/Lever – Quick Fit

F1 Silver	3311744
F3 Gold	3311761
White	3311787
Black	3311795
Chrome	3258242

Colour Standard Backplate
92mm PZ Long Backplate
62/92mm PZ

Tokyo Lever/Moving Pad – Monobloc

F1 Silver	2758878	2760847
F3 Gold	-	-
White	2758966	2760943
Black	2758982	2760960
F49 Resista Chrome	2368044	2176077

Monobloc = Handle levers are supplied fixed to backplate.

Quick Fit = Patented handle fixing design. Handle set can be fitted in as little as 8 seconds. Levers are supplied separate from backplate.